

# iPhone IMAP setup

---

Settings->Mail,Contacts and Calendars

Add Account, Other, Add Mail Account

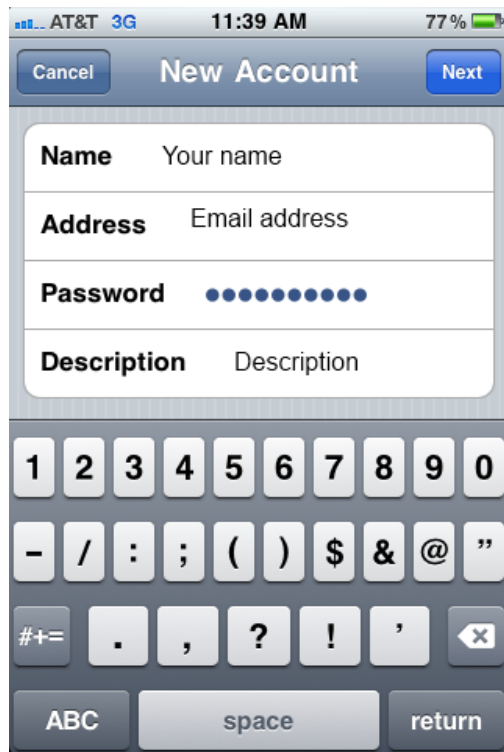

Enter **mail.myserver1.net** for the incoming and outgoing mail server host name.

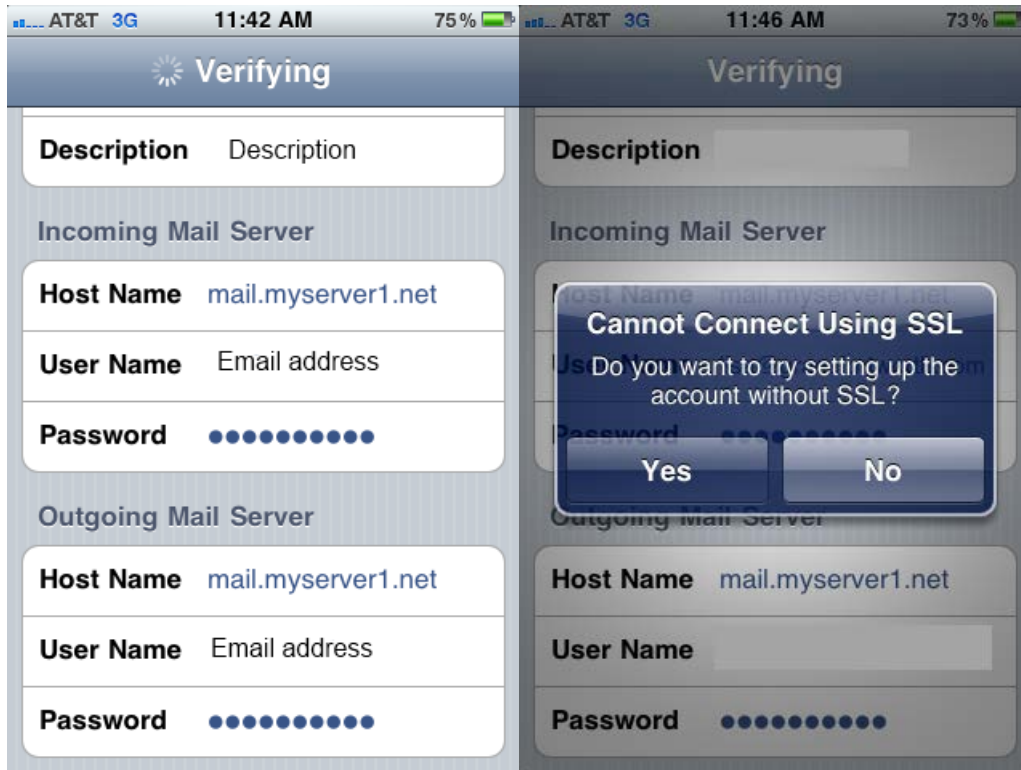

After it tries to verify the account settings, it will come up with the error “Cannot connect using SSL”. Press Yes to continue setting the account up without SSL.